



## QUICK START GUIDE

USB-C Triple 4K  
Display Universal Docking Station



[www.wavlink.com/en\\_us/WL-UG69PD25\\_Pro](http://www.wavlink.com/en_us/WL-UG69PD25_Pro)

Scan the QR code or load the link for  
Quick Start Guide and Driver downloading

WL-UG69PD25 Pro



WAVLINK (@WavlinkOfficial)  
WAVLINK SUPPORT (@WavlinkTechSupport)

### Safety Instructions

Always read the safety instructions carefully.  
Keep this Quick Start Guide for future reference.  
If any of the following situation arises, get the equipment checked by a service technician:  
• The equipment has been exposed to moisture.  
• The equipment has been dropped and damaged.  
• The equipment has obvious sign of breakage.  
• The equipment has not been working well or you cannot get it work according to quick start guide.

### Copyright Statement

No part of this publication may be reproduced in any form by any means without the prior written permission.  
Other trademarks or brand names mentioned herein are trademarks or registered trademarks of their respective companies.

### Disclaimer

Information in this document is subject to change without notice. The manufacturer does not make any representations or warranties (implied or otherwise) regarding the accuracy and completeness of this document and shall in no event be liable for any loss of profit or any commercial damage, including but not limited to special, incidental, consequential, or other damage.

### WEEE Directive & Product Disposal



At the end of its serviceable life, this product should not be treated as household or general waste. It should be handed over to the applicable collection point for the recycling of electrical and electronic equipment, or returned to the supplier for disposal.

- 1 -

### Overview

#### Front View

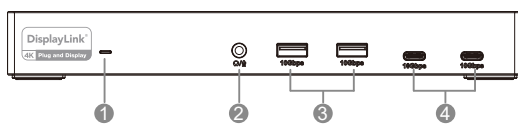

- 1 Power LED
- 2 4-Pole Earphone Jack
- 3 USB-A Port(10Gbps)
- 4 USB-C Port(10Gbps)

#### Rear View

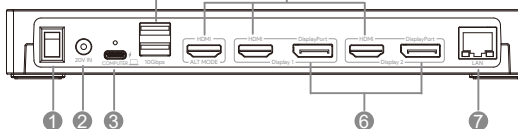

- 1 Power Switch
- 2 DC IN (20V/8A, 160W)
- 3 USB-C Port(host, PD100W)
- 4 USB-A 3.1 Port(10Gbps)
- 5 HDMI Port
- 6 DisplayPort
- 7 Gigabit Ethernet Port

- 2 -

### System Requirement

- CPU i5 or higher, RAM 4GB or above
- Microsoft Windows 7/8/10 to the latest
- Apple Mac OS 10.X to the latest
- Requires your USB-C USB 3.1 full function with Data Transfer, USB-C Power Delivery and Video Alternate Mode

### Specification

- Compatible with Type-C USB 3.1 Gen 2 full specification PC Computer.
- USB Power Delivery with 5 profile supports 100Watts upstream charging.
- Two DisplayPort and three HDMI ports provide resolution up to 3840x2160@60Hz.
- Built in Gigabit Ethernet port provides stable network speed for your working and gaming and is backward compatible with 10/100Mbps network.
- Built in 4-pole phone Jack for stereo audio out and microphone in.
- Downstream four USB 3.1 Type-A ports and two 3.1 Type-C ports.

### In the Box

- 1 x USB-C Triple 4K Display Universal Docking Station
- 1 x USB-C to C Cable (E-Mark Chip)
- 1 x 20V/8A 160W Power Adapter
- 1 x Quick Start Guide
- 1 x Driver Link Card

- 3 -

### Cable Holder Connection

The cable holder is designed to tighten the USB-C cable. If you are worried that the USB-C cable might loosen, please follow the following steps to install the cable holder to the dock.

1. Insert the cable into the cable holder according to the arrow direction.

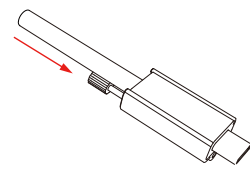

2. Align the bolt with the fixing hole, then please connect it to the host Type-C port.

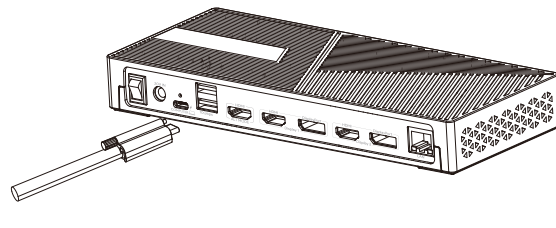

- 4 -

3. Fasten the bolt and fix the connectivity between the cable and the dock.

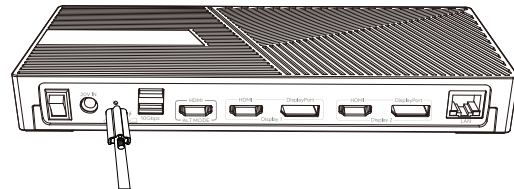

**Note:**  
The USB-C(host) port provides maximum 100W power charging for your laptop.

### How to Set Up

Before using this dock, please visit  
[www.wavlink.com/en\\_us/WL-UG69PD25](http://www.wavlink.com/en_us/WL-UG69PD25) or follow: **Support-> Driver** to download the corresponding driver for the dock step by step.  
If you want to extend external monitors, please do as the following:

1. Connect the USB-C port(host) to your laptop.

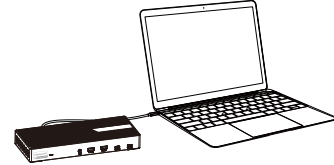

- 5 -

2. Connect the external monitors to the dock, can connect up to three monitors.

#### 2.1 Single Display

1. Connect your host laptop to USB-C port of the dock.
2. Connect your monitor to the HDMI 1, HDMI 2/DisplayPort 2 or HDMI 3/DisplayPort 3.
3. Connect this docking station to the power outlet.

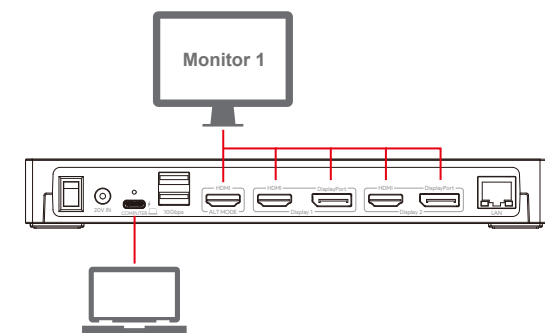

**Note:**  
In Display 1 and Display 2, DisplayPort and HDMI port cannot be used simultaneously, thus, you can only use one port in each video stream group.

Video Port	HDMI 1(ALT Mode)	HDMI 2/DisplayPort 2	HDMI 3/DisplayPort 3
DP Version of PC/Laptop	DP1.2	3840*2160@30Hz	3840*2160@60Hz
	DP1.4	3840*2160@60Hz	3840*2160@60Hz

- 6 -

#### 2.2 Dual Display

1. Connect your host laptop to USB-C port of the dock.
2. Connect Monitor 1 to the HDMI 1 port.
3. Connect Monitor 2 to the HDMI 2/DisplayPort 2 or HDMI 3/DisplayPort 3 port.
4. Connect this docking station to the power outlet.

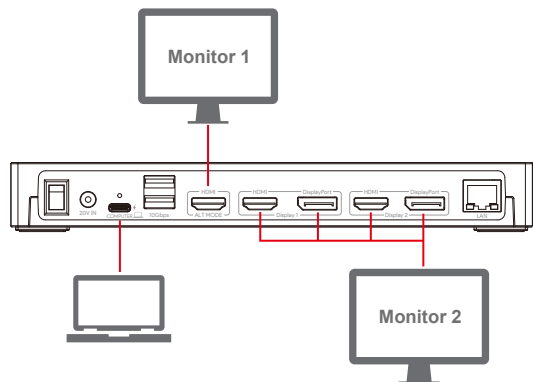

**Note:**  
In Display 1 and Display 2, DisplayPort and HDMI port cannot be used simultaneously, thus, you can only use one port in each video stream group.

Video Port	HDMI (ALT Mode)+Display 1/2	Display 1+Display 2
DP Version of PC/Laptop	DP1.2	3840*2160@30Hz
	DP1.4	3840*2160@60Hz

- 7 -

#### 2.3 Triple Display

1. Connect your host laptop to USB-C port of the dock.
2. Connect Monitor 1 to the HDMI 1 port.
3. Connect Monitor 2 to the DisplayPort 2/HDMI 2 port.
4. Connect Monitor 3 to the DisplayPort 3/HDMI 3 port.
5. Connect the docking station to the power outlet.

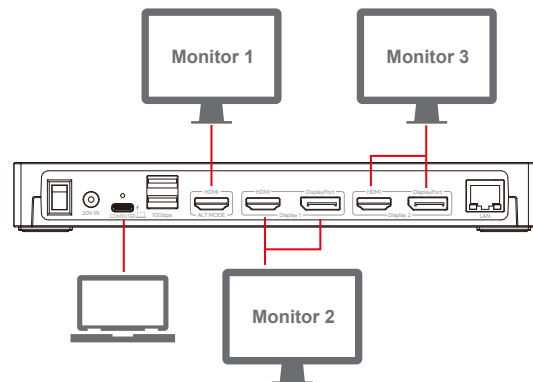

**Note:**  
In Display 1 and Display 2, DisplayPort and HDMI port cannot be used simultaneously, thus, you can only use one port in each video stream group.

Video Port	HDMI 1(ALT Mode)+HDMI 2/DisplayPort 2 +HDMI 3/DisplayPort 3
DP Version of PC/Laptop	DP1.2
	3840*2160@60Hz
	DP1.4
	3840*2160@60Hz

- 8 -

### Software Installation

#### Windows Installation

1. Select Driver for Windows and then double click the **Setup.exe** to launch the installation wizard.

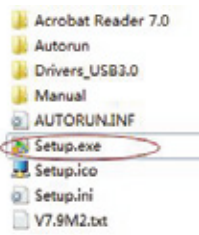

2. Follow the on-screen instructions until the installation is completed. Then reboot the computer when prompted.

- 9 -

#### Installation for Mac OS

1. Download the latest driver for your mac OS system on [www.wavlink.com/en\\_us/WL-UG69PD25](http://www.wavlink.com/en_us/WL-UG69PD25) website.
2. Locate the download folder and double-click the driver you just downloaded.
3. Double-click the "DisplayLink Software Installer.pkg" file then this menu may show up (it depends on your security settings), click "OK" to proceed if it does.

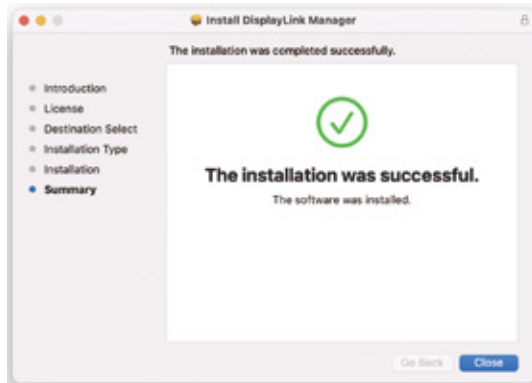
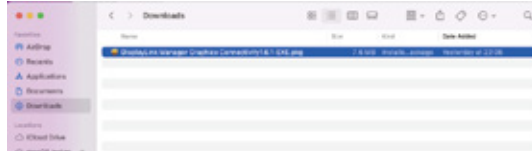

- 10 -

4. Navigate to **Applications** and then open **DisplayLink Manager**.

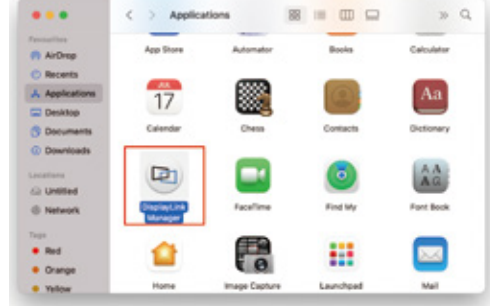

5. Click the **DisplayLink Manager** application icon in the notification area to open the application window. This confirms that the software is installed and running properly.

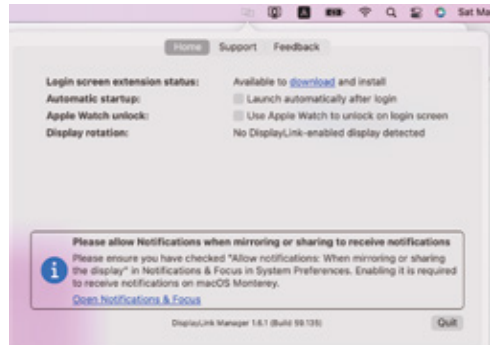

- 11 -

6. Select "Launch automatically after logging-in" for the software to start automatically every time you log-in.  
**Note:** this is not compulsory but recommended to save you from repeating step 3 each time you login

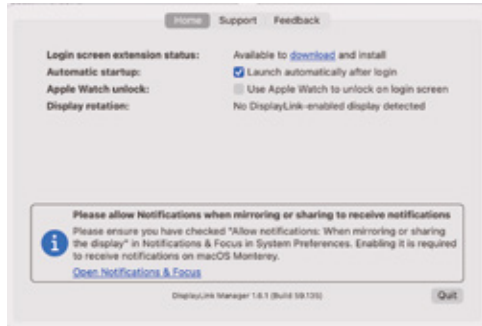

7. Now connect peripherals using DisplayLink technology and navigate to your **System Preferences** to turn on **Security & Privacy**

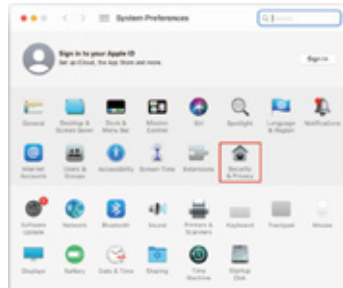

- 12 -

8. Enable "Screen Recording" to allow the DisplayLink Manager application to capture pixels and send them to your USB peripheral:  
8.1 Please select "Privacy" tab.  
8.2 Navigate to "Screen Recording" in the list on the left.  
8.3 Then tick the "Screen Recording" permission for DisplayLink Manager.

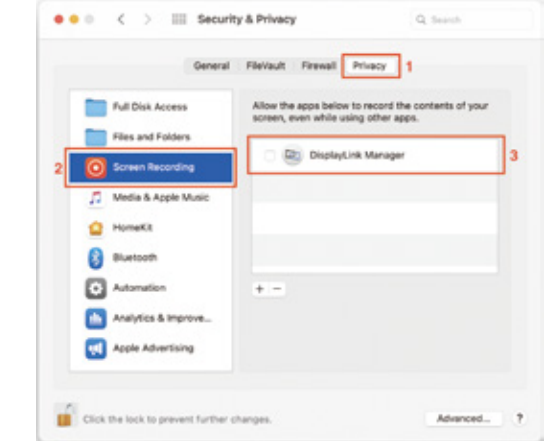

- 13 -

9. If you have enabled notifications from **DisplayLink Manager**, it will remind you to allow screen recording when it detects that this permission is missing.

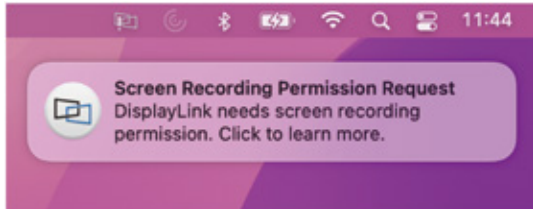

10. The notification will also appear in the **DisplayLink Manager** window.

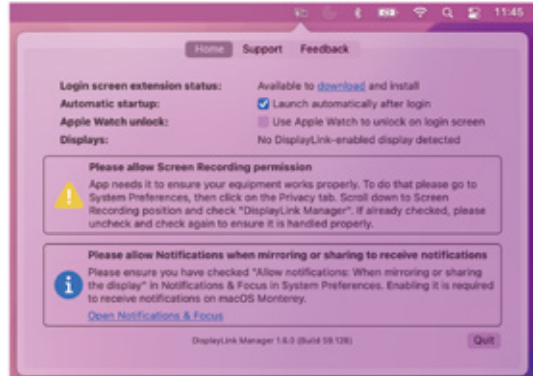

- 14 -

11. Because the new permissions will only take effect the next time you launch the app, macOS invites you to "quit and reopen". In Catalina 10.15.x, select "Sign Out Now", please accept.

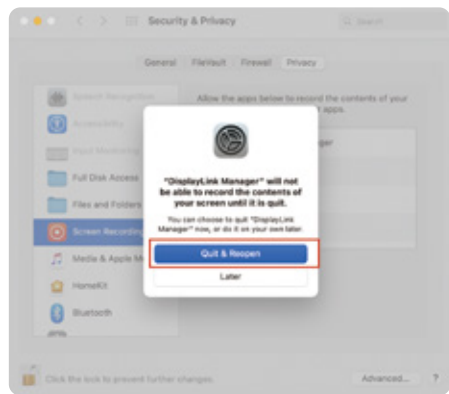

12. Now that it has sufficient permissions, reopen the **DisplayLink Manager** from the application in the **Finder**. On mac OS Big Sur the application will automatically restart.

13. Your monitor is now working properly.

- 15 -

### Display Settings

Before configuring the settings, please make sure this docking station has been connected to your laptop and monitors correctly.

#### For Windows

1. Right-click->**Display settings**.



2. In "Display", you can enjoy different operations of duplicating, extending and rotating on your monitors.



- 16 -

#### For Mac OS

1. Click Apple icon->**About This Mac**.
2. Click **Displays->Displays Preferences**.

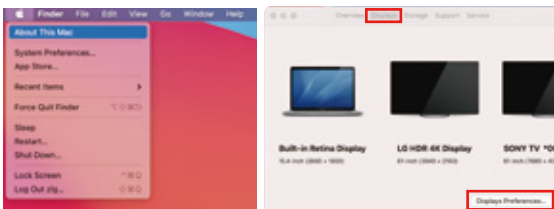

3. In "Display", you can enjoy different operations of mirroring, expanding and rotating on your monitors.

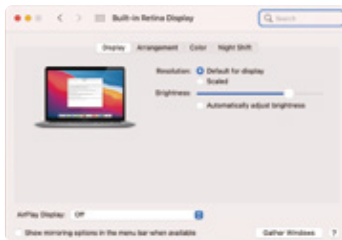

4. Or click "Gather Windows" to gather all connected displays and make separate settings.

- 17 -

### FAQ

#### Q 1: Why does my dock get hot when I use it?

**A1:** This is what it's supposed to be like when the dock is working, don't worry about the heat. But we suggest that you put the dock in a relatively open area for a better heat dissipation.

#### Q2: Why is there no display after I connect the dock to the USB-C port of my laptop?

**A2:** Please make sure that your laptop is the latest version, and you have installed the latest driver. At last, please check if the Type-C port of your laptop port supports data transmission.

#### Q3: What should I do if the dock cannot deliver power to my host laptop?

**A3:** Please make sure that your laptop supports USB-C power delivery.

#### Q4: Why can't I extend my display monitors?

**A4:** Please make sure your dock is recognized in "task management" and make sure you have installed the latest drivers.



Thank you for purchasing  
WAVLINK product!

Official website: [www.wavlink.com](http://www.wavlink.com)  
Technical support: [support@wavlink.com](mailto:support@wavlink.com)

- 18 -